

St Marys, York £825 PCM

Situated in a quiet residential street off Bootham and a short walk from the Museum Gardens, this newly renovated, one bedroom apartment is located on the lower ground floor of a classic early Victorian townhouse. Located 10 minutes walk from York railway station via Scarborough bridge, entry to the lower ground floor apartment is via the main communal entrance hall.

No smokers. No pets



On the lower ground floor, there is a private entrance door, entrance hall with built in storage cupboard and open plan lounge kitchen with breakfast bar. Sash window looks out on to forecourted gardens giving the living area a bright and pleasant outlook

KITCHEN - Fitted units, electric cooker and ceramic hob with extractor fan, fridge freezer, electric water heater. Washing machine is in a separate area



LIVING AREA - Recently recarpeted and decorated there is built in storage and shelving. Breakfast bar seating

BEDROOM - Situated to the front of the property with high window and electric heating

BATHROOM - Benefitting from separate bath and shower

Outside

GARDEN - Small communal fore courted garden area

PARKING - Permit parking via York City Council is available



St Mary's, Bootham, York, YO30 7DD

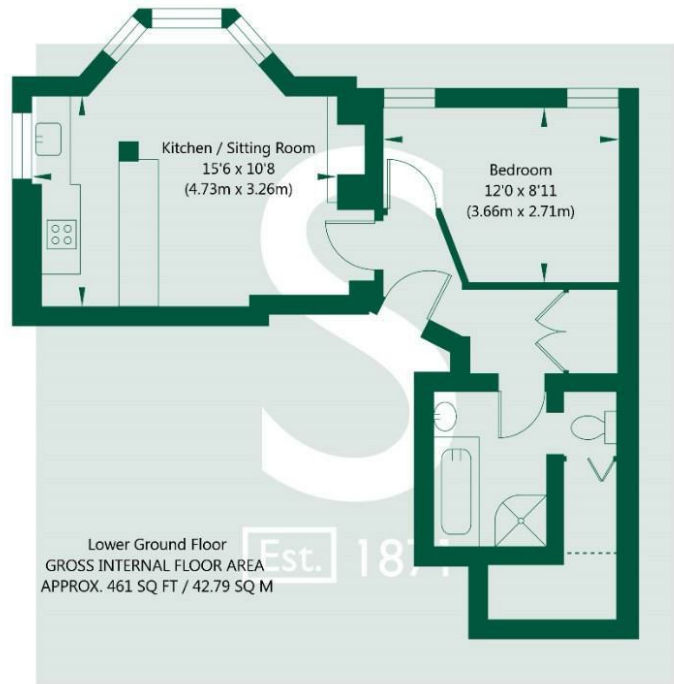

NOT TO SCALE - FOR ILLUSTRATIVE PURPOSES ONLY
 APPROXIMATE GROSS INTERNAL FLOOR AREA 461 SQ FT / 42.79 SQ M
 All measurements and fixtures including doors and windows are approximate and should be independently verified.
 www.exposurepropertymarketing.com © 2021



Stephensons

York	01904 625533
Knaresborough	01423 867700
Selby	01757 706707
Boroughbridge	01423 324324
Easingwold	01347 821145
York Auction Centre	01904 489731
Haxby	01904 809900

Partners

J F Stephenson MA (cantab) FRICS FAAV
 I E Reynolds BSc (Est Man) FRICS
 R E F Stephenson BSc (Est Man) MRICS FAAV
 N J C Kay BA (Hons) pg dip MRICS
 O J Newby MNAEA
 J E Reynolds BA (Hons) MRICS
 R L Cordingley BSc FRICS FAAV
 J C Drewniak BA (Hons)

Associates

CS Hill FNAEA
 N Lawrence

